



Shorncliffe Garrison Masterplan



Transport Strategy Summary

DESCRIPTION OF WORKS	ESTIMATED DATE OF IMPLEMENTATION / TRIGGER POINT	NOTES	ESTIMATED COST
Signalisation of the Risborough Lane / Church Road junction plus entry treatment works to Oaks Road	2016 or prior to completion of Phase 1	All works to existing highway include allowance for drainage, lighting improvements , an estimate of any earthworks requirements plus commuted sum payments - they exclude any costs associated with the diversion of Statutory Services	130000
Signalisation of the Risborough Lane / Shorncliffe Road junction plus entry treatment works to Heritage Road	2021 or prior to completion of Phase 2		105000
Works to Stanley Road to improve operation of A20 Cheriton High Street / B2063 Risborough Lane junction	2021 or prior to completion of Phase 2		60000
Signalisation of the A20 Cheriton High Street / Cheriton High Street junction	2021 or prior to completion of Phase 2		570000
Works to existing traffic signals junction at Cheriton High Street / Horn Street	2021 or prior to completion of Phase 2		245000
Works to improve forward visibility through Horn Street railway bridge plus upgrade of pedestrian bridge	2016 or prior to completion of Phase 1		80000
Travel Plan Set Up	At start of development period - 2013	Includes set up for CIC, TPC, Community Website & pump priming of TP measures / initiatives	50000
On-going costs of maintaining Travel Plan	Annual cost	Allows for monitoring / review, analysis of travel patterns, TPC costs, personalised travel planning etc. - approx. cost. £6,000 per annum over period of 13 years (end of LDF Core Strategy)	78000
KCC TP Monitoring Fees	Annual Cost	Assume 1000 per annum	10000



DESCRIPTION OF WORKS	ESTIMATED DATE OF IMPLEMENTATION / TRIGGER POINT	NOTES	ESTIMATED COST
Pump Priming of Bus Infrastructure to Deliver Enhanced Connections to Folkestone West & Town Centre	From commencement of Phase 2, i.e. 2016 - 2024	Cost of additional vehicle + driver (120000 per annum) - assumes 8 year pump priming period before service is commercial - excludes any revenue return	960000
PROW Improvements	2016 or prior to completion of Phase 1	Links across Backdoor Training Area & Seabrook Valley	55000
Upgrade of existing footpath linking Church Road and Cheriton High St	2021 or prior to completion of Phase 2	Includes upgrade of footbridge over London - Folkestone railway line (resurfacing, new edging, lighting enhancements)	25000
TOTAL COST			£2,368,000
Cost to end of Phase 1 (2016)			£256,000
Cost to end of Phase 2 (2021)			£1,760,000
Cost to end of Phase 3 (2026)			£352,000



Shorncliffe ERDP Figure No. 04	
Shorncliffe Garrison: A20 Cheriton High Street / Cheriton High Street	
Rev.	Drawn by. KL
Scale. 1:1000	Date. 13/05/2011
 Defence Infrastructure Organisation	

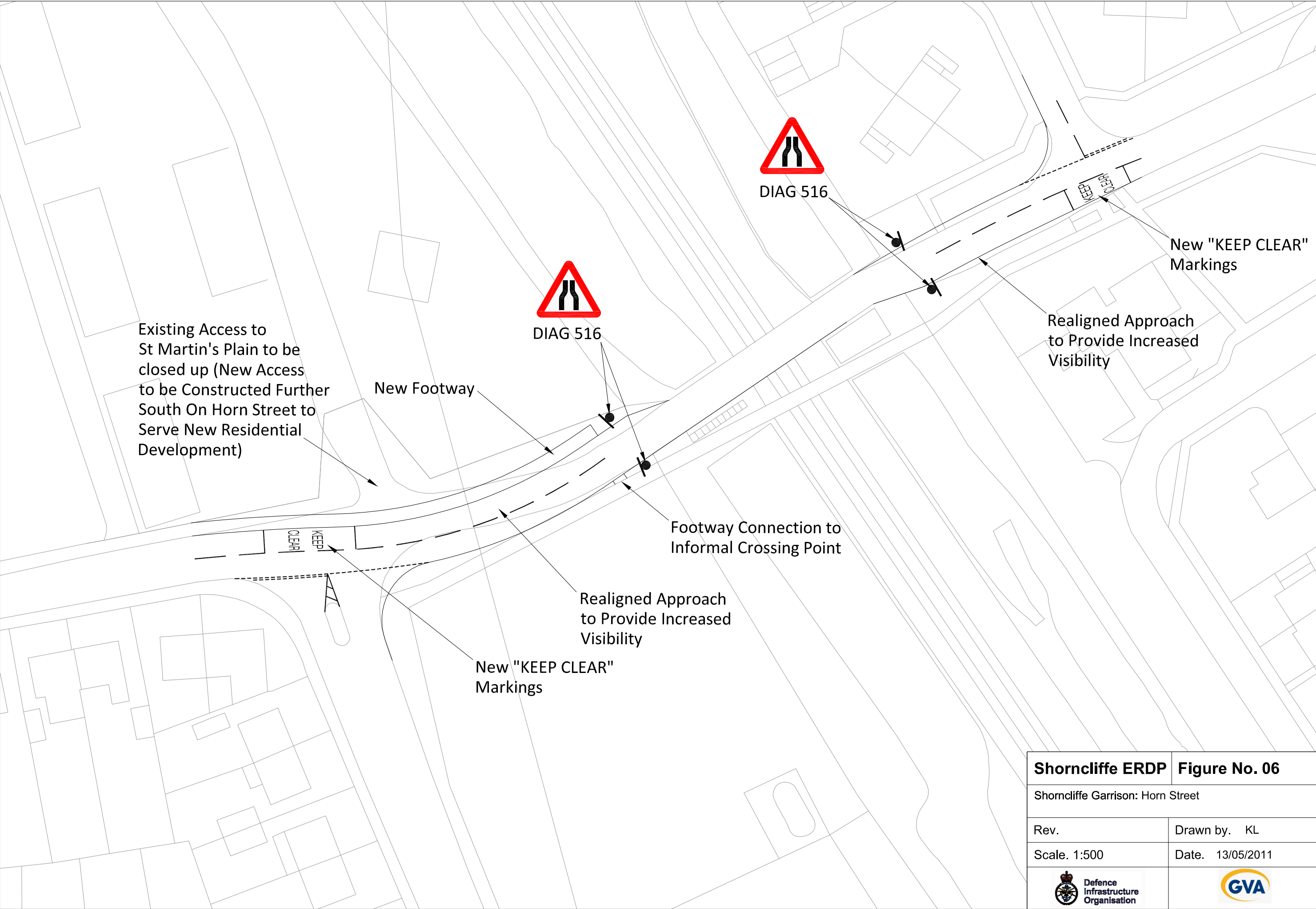

Shorncliffe ERDP Figure No. 06



Shorncliffe Garrison: Horn Street

Rev. Drawn by. KL

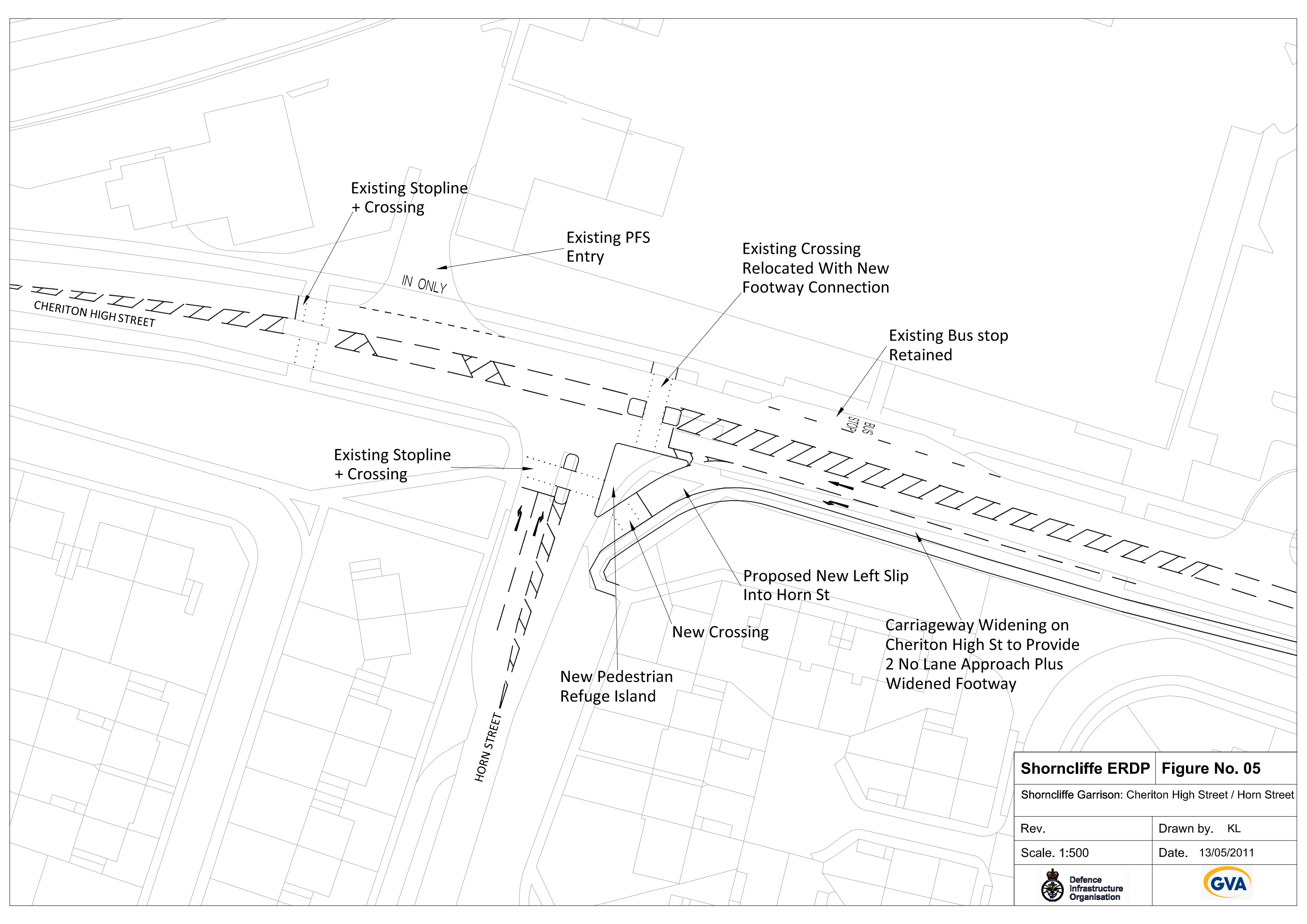

Scale. 1:500 Date. 13/05/2011





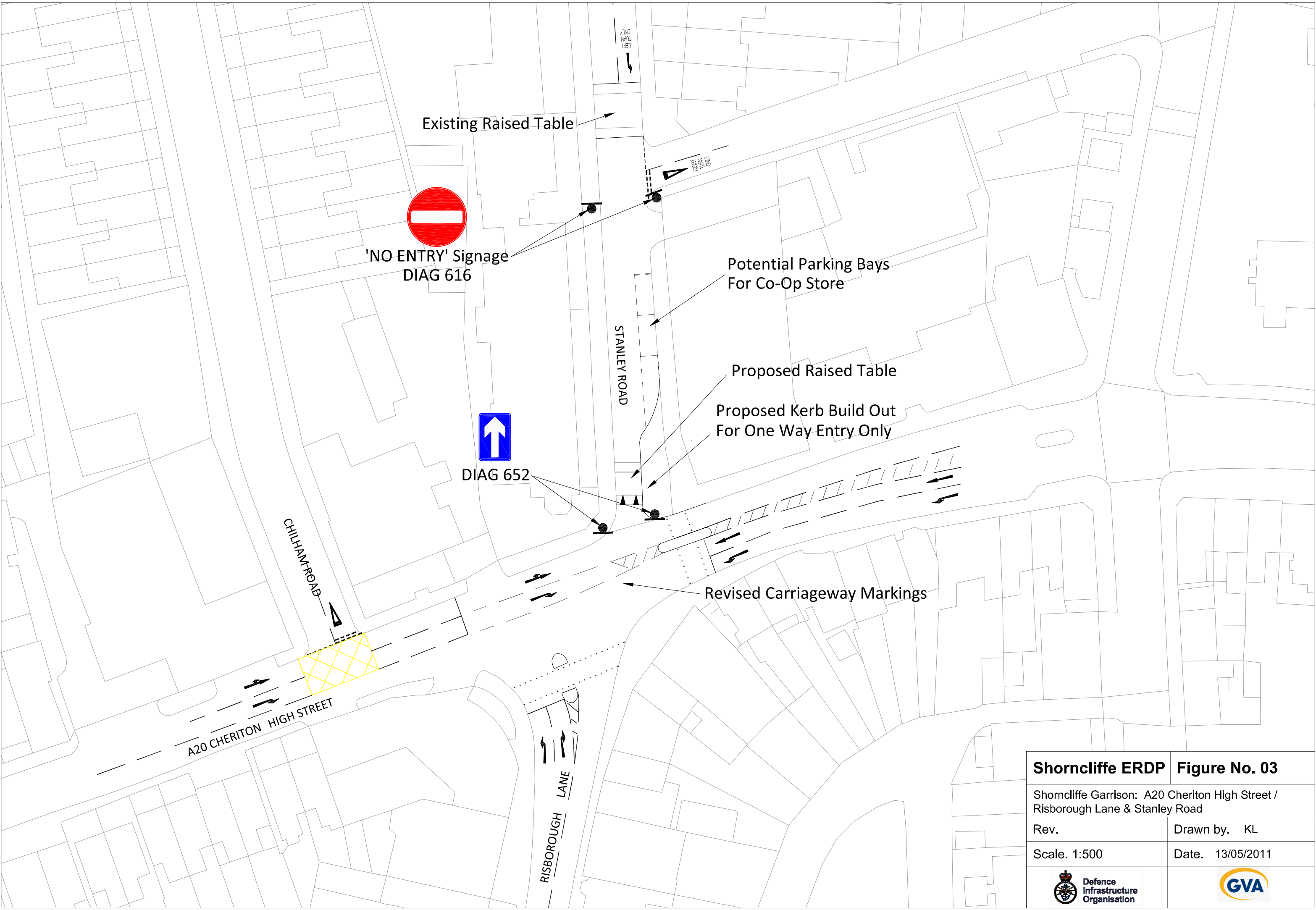

Shorncliffe ERDP Figure No. 05	
Shorncliffe Garrison: Cheriton High Street / Horn Street	
Rev.	Drawn by. KL
Scale. 1:500	Date. 13/05/2011
 Defence Infrastructure Organisation	

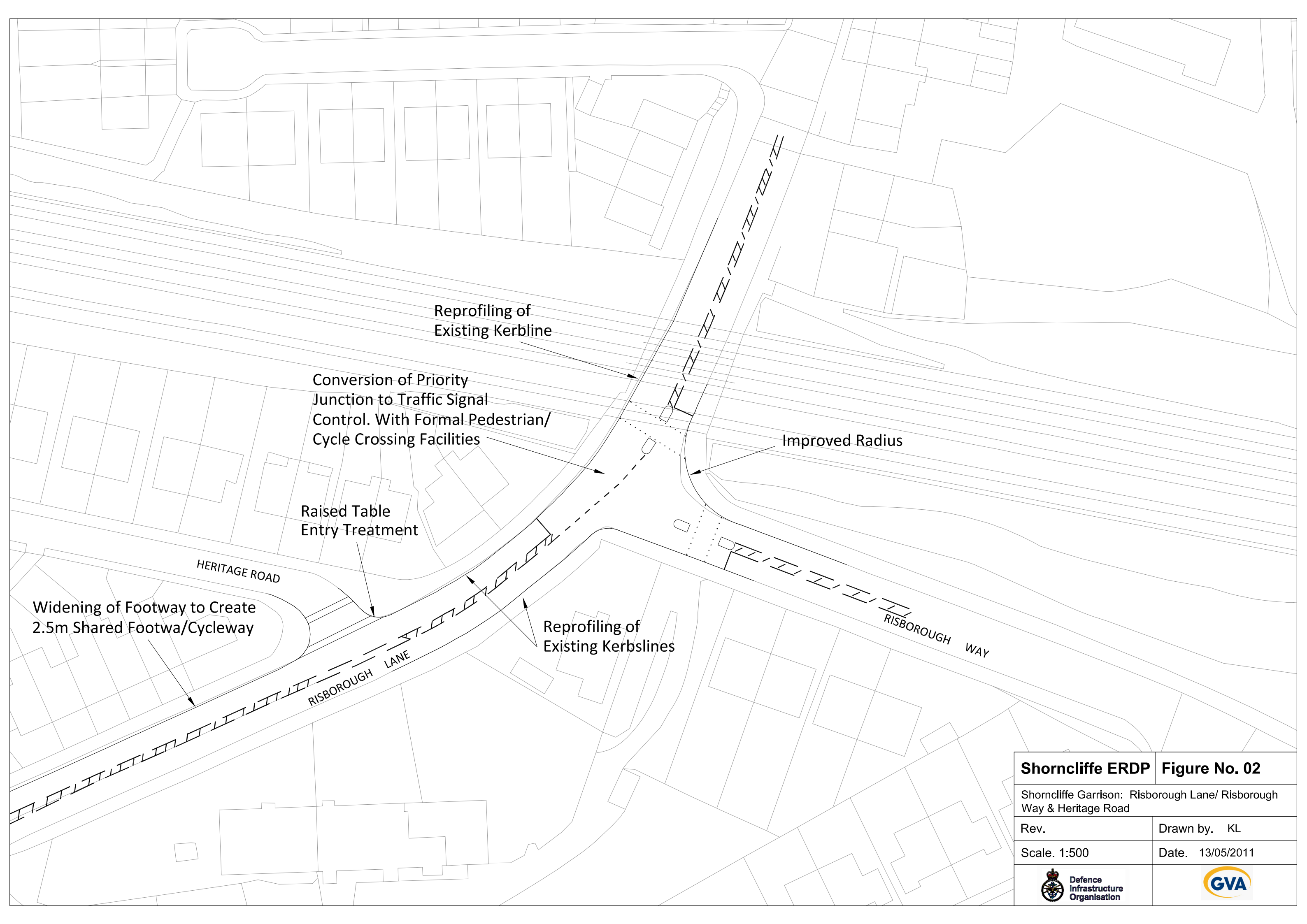

Shorncliffe ERDP Figure No. 03	
Shorncliffe Garrison: A20 Cheriton High Street / Risborough Lane & Stanley Road	
Rev.	Drawn by. KL
Scale. 1:500	Date. 13/05/2011
 Defence Infrastructure Organisation	



Shorncliffe ERDP Figure No. 02	
Shorncliffe Garrison: Risborough Lane/ Risborough Way & Heritage Road	
Rev.	Drawn by. KL
Scale. 1:500	Date. 13/05/2011
 Defence Infrastructure Organisation	

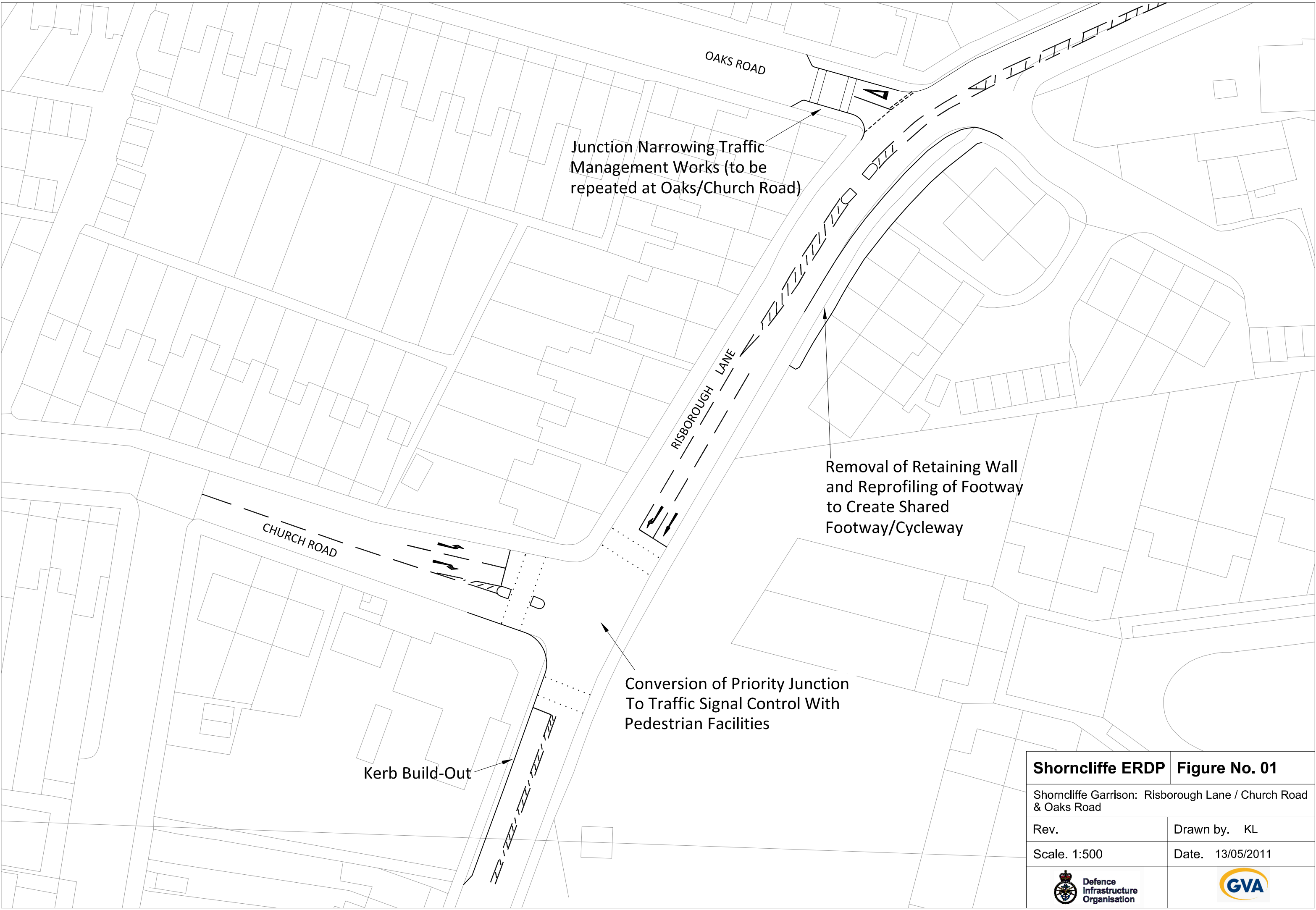

Shorncliffe ERDP Figure No. 01	
Shorncliffe Garrison: Risborough Lane / Church Road & Oaks Road	
Rev.	Drawn by. KL
Scale. 1:500	Date. 13/05/2011
 Defence Infrastructure Organisation	