

PHASE 1A
Middelburg Square
Footway works

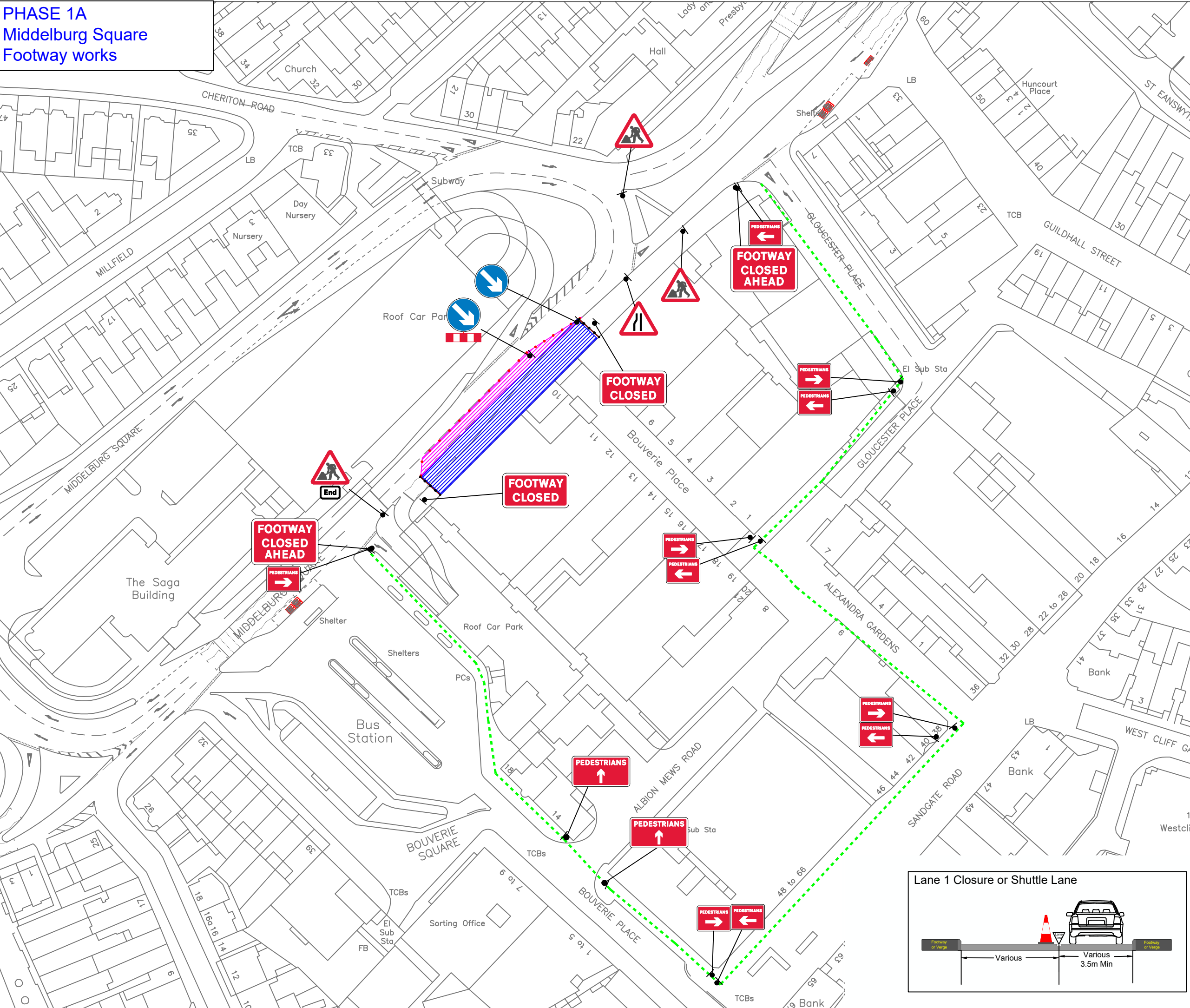

Sapphire House | Clifton Lane | Runcorn | Cheshire | WA7 3FP
Office: 01928 751 761 | Fax: 01928 751 602 | Email: admin@batml.co.uk | Web: www.batml.co.uk

DO NOT SCALE FROM THIS DRAWING.
All measurements are in meters unless otherwise stated.

Signage to be agreed on site

WORKS ACCESS WORKS EXIT

- Traffic Management Notes:
- 1) All temporary traffic management shall be in accordance with Chapter 8 of the Traffic Signs Manual 2016, Traffic Signs Regulations and General Directions 2013 and the Safety at Street Works and Road Works, A Code of Practice, 2013.
 - 2) All temporary traffic management locations are indicative to help clarity and are subject to approval from the on site client.
 - 3) All carriageway widths to be a minimum of 3.25m wide unless otherwise shown.
 - 4) This drawing has been specifically prepared to meet the requirements of the named client and may contain design or innovative features which differ from conventional design standards.
 - 5) Upon installation the TM Foreman is responsible for ensuring the design of the traffic management meets the on site requirements, Chapter 8 standards and any modifications as necessary.

Site location:	Middelburg Square, Folkestone, Kent, CT20 1EU	
What 3 Words:	certified.reaction.booms	Phase 1A
Traffic Management:	Lane Closure	
Authority:	Kent County Council	
Scale	Date	Drawn by
@A3	20/03/2025	SB
DWG no:	PHASE 1A-4257 - MSW - Footway works	Checked By
Rev:	Description:	ZW
<div><div><div>KEY</div><div><div>Traffic sign</div><div>Traffic cone</div><div>Pedestrian Diversion</div><div>Working Space</div><div>Coned safety area</div><div>Pedestrian Barrier</div><div>CLIENT</div></div><div><div>1) ALL SIGNS TO BE MINIMUM 750MM HIGH</div><div>2) SIGNS TO BE PRESTANDING SECURED USING SANDBAGS</div><div>3) ALL CONES TO BE 1M</div><div>4) TRAFFIC SIGNALS TO BE SET TO VEHICLE ACTIVATION</div><div>5) TEMPORARY BARRIERS TO BE INSTALLED WHERE PEDESTRIANS CROSS ONTO ROAD</div></div></div><div></div></div>		

- Lane Closure
- 1 All traffic signs shall comply with Chapter 8 of the traffic Signs Manual
 - 2 All traffic management equipment shall be provided by the Contractor, unless otherwise specified.
 - 3 All signs shall be positioned so as not to be obscured by any other objects and shall not obstruct any other sign, permanent or temporary as much as is reasonably practicable.
 - 4 The minimum lateral clearance between any area in which work is being carried out and that part of the carriageway available to traffic shall be 0.5m for roads with a speed limit of 40 mph or less and 1.2m for motorways and roads with a speed limit of 50 mph or more.
 - 5 All traffic signs shall meet the reflectorisation requirements of BS 873 : Part 6 : 1983, Table 1.
 - 6 The permitted use of given types of closure shall be as specified.
 - 7 Constraints on the use of given types of closure shall be as specified.
 - 8 The lengths of tapers shown on the standard lane closure drawings are based on a basic lane width of 3.65m, rounded up to generally the nearest 5m. Where the actual lane width varies from this figure the following shall be used to calculate taper lengths:
Single carriageway road (speed limit 30 mph or less) - Rate of Taper 1 in 13
Single carriageway road (speed limit 40 mph) - Rate of Taper 1 in 20
Single carriageway road (speed limit 50 mph or more) - Rate of Taper 1 in 25
Dual carriageway road without Hard Shoulder (speed limit 40 mph or less) - Rate of Taper 1 in 25
Dual carriageway road without Hard Shoulder (speed limit 50 mph or more) - Rate of Taper 1 in 32
Dual carriageway road with Hard Shoulder (any speed limit) - Rate of Taper 1 in 55
Motorway (any speed limit) - Rate of Taper 1 in 55.
 - 9 Works Access/Egress to be positioned to suit ongoing works.

