

Shorncliffe Road junction
Phase 1B – New drainage works

Shorncliffe Road closed Westbound with traffic diverted via Bouverie Road West and Castle Hill Avenue
Pedestrians using opposite footway/cycleways via crossing points further along Cheriton Road.
Bespoke access/delivery arrangements for adjacent properties throughout.

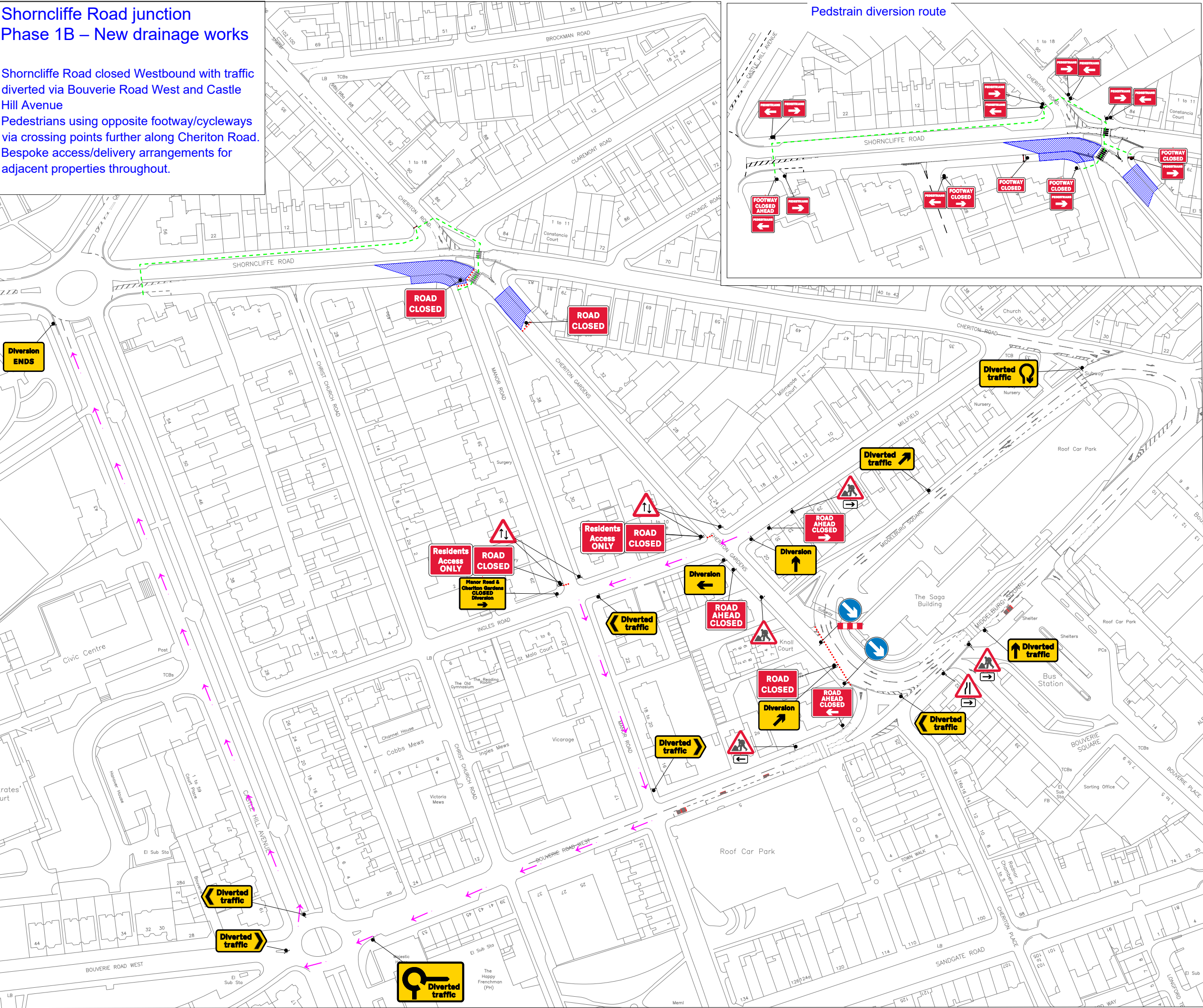

Pedstrain diversion route

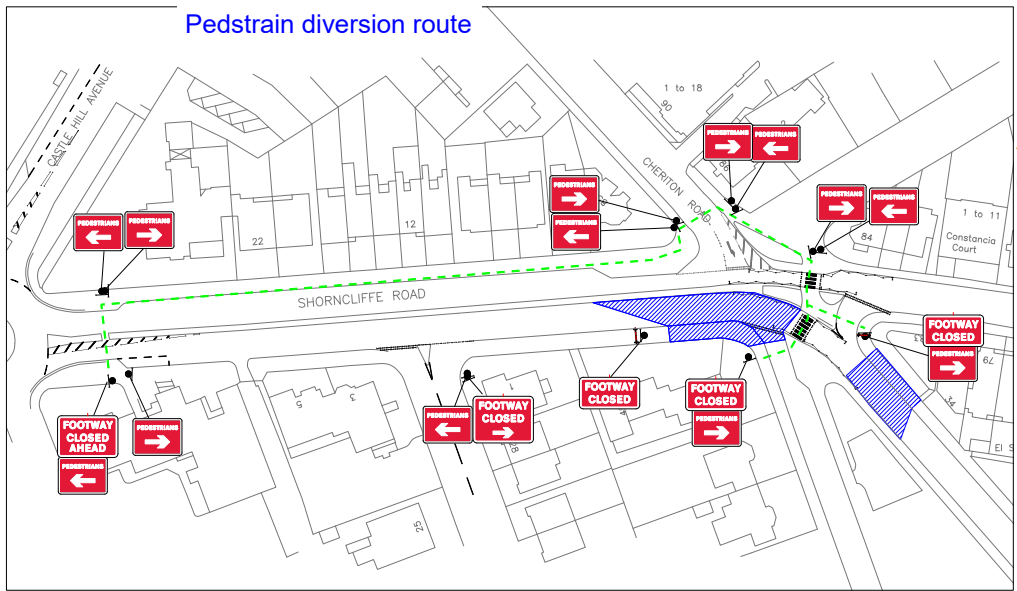

Office: 01928 751 761 | Fax: 01928 751 602 | Email: admin@batml.co.uk | Web: www.batml.co.uk

Sapphire House | Clifton Lane | Runcom | Cheshire | WA7 3FP

LANTRA AWARDS
national highway sector schemes

NHS
national highway sector schemes

constructionline
Accredited Contractor

ISO 9001
Registered
Quality
Management

DO NOT SCALE FROM THIS DRAWING.
All measurements are in meters unless otherwise stated.

Signage to be agreed on site

Traffic Management Notes:

1) All temporary traffic management shall be in accordance with Chapter 8 of the Traffic Signs Manual 2016, Traffic Signs Regulations and General Directions 2013 and the Safety at Street Works and Road Works, A Code of Practice, 2013.

2) All temporary traffic management locations are indicative to help clarity and are subject to approval from the on site client.

3) All carriageway widths to be a minimum of 3.25m wide unless otherwise shown.

4) This drawing has been specifically prepared to meet the requirements of the named client and may contain design or innovative features which differ from conventional design standards.

5) Upon installation the TM Foreman is responsible for ensuring the design of the traffic management meets the on site requirements, Chapter 8 standards and any modifications as necessary.

Site location:	Shomcliffe Road, Folkestone Kent, CT20 2SF		
Phase	Phase 1B		
Traffic Management:	Road Closure / Diversion route & Pedestrian Management		
Authority:	Kent County Council		
Scale	Date	Drawn by	
@A3	19/01/2026	SB	
DWG no:	PHASE 1B - 4257 - Shorncliffe Jnc - New Drainage Works		Checked By
Rev:	Description:	ZW	

KEY

- Traffic sign
- Traffic cone
- Diversion route
- Closure area
- Pedestrian Barrier
- Temporary refuse island

1) ALL SIGNS TO BE MINIMUM 700MM HIGH
2) SIGNS TO BE PRESTANDING SECURED USING SANDBAGS
3) ALL CONES TO BE 1M
4) TRAFFIC SIGNALS TO BE SET TO VEHICLE ACTIVATION
5) TEMPORARY RAMP TO BE INSTALLED WHERE PEDESTRIANS CROSS ONTO ROAD

CLIENT

ROAD CLOSURE

- All traffic signs shall comply with Chapter 8 of the Traffic Signs Manual
- All traffic management equipment shall be provided by the Contractor, unless otherwise specified.
- All signs shall be positioned so as not to be obscured by any other objects and shall not obstruct any other sign, permanent or temporary as much as is reasonably practicable.
- All traffic signs shall meet the reflectorisation requirements of BS 873 : Part 6 : 1983, Table 1.
- Works Access/Egress to be positioned to suit ongoing works.